

# SUMMIT™

## 2196 ANSI POWER ENDS

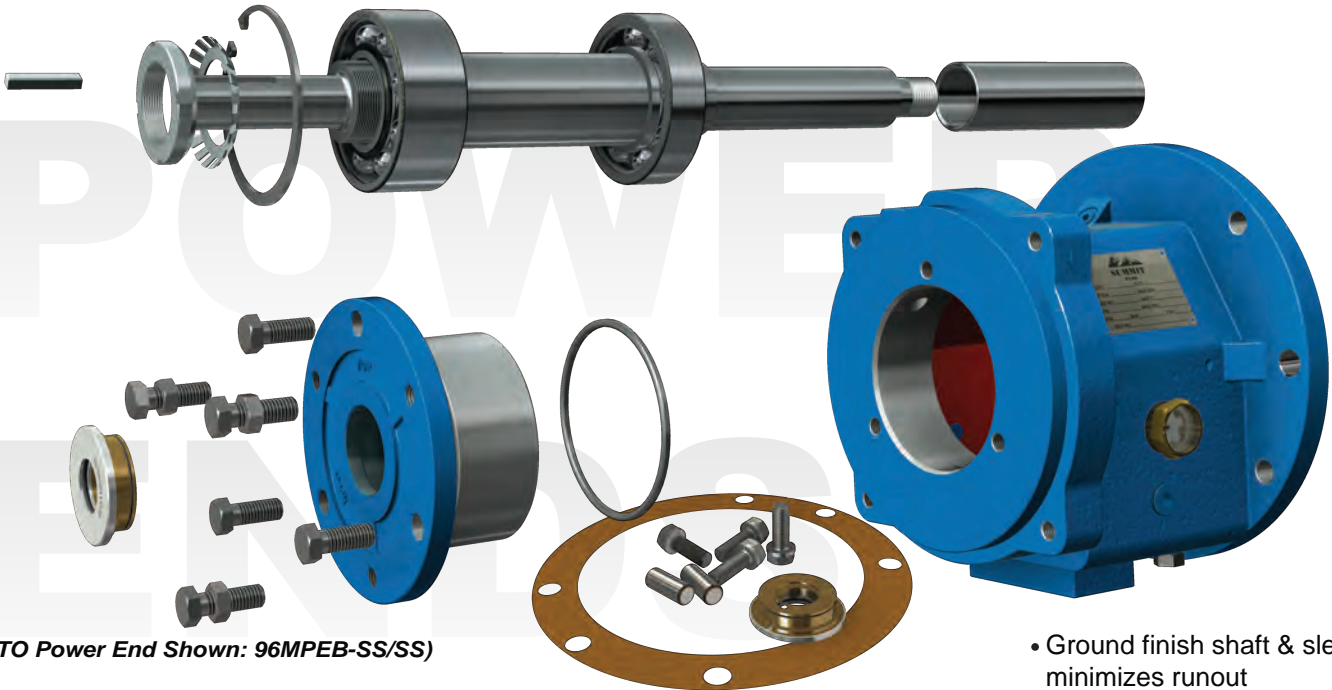

(MTO Power End Shown: 96MPEB-SS/SS)

Summit Pump's Power Ends are an ideal stock item. Power Ends are interchangeable with the following Power Ends:

- 2196 ANSI
- 2196 LF
- 2196 R
- 2796 (Self-Primer)

Power Ends maximize inventory and reduces downtime saving time and money. Power Ends are available in all frame sizes:

- STO
- LTO
- MTO
- XLO

**Forever  
Frame™**  
ALL 316 STAINLESS STEEL PRODUCTS

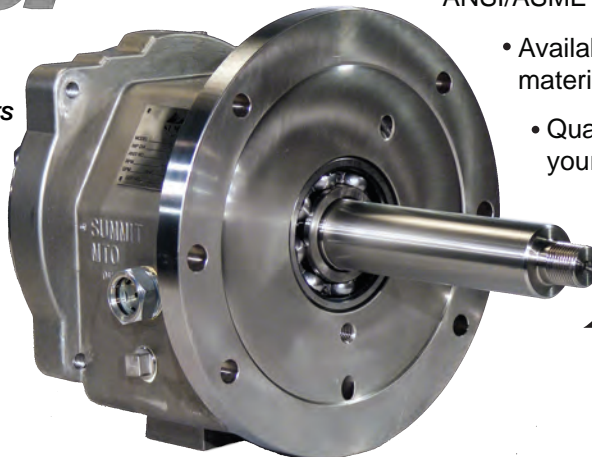

**SUMMIT™**  
PUMP, Inc

[www.SUMMITPUMP.com](http://www.SUMMITPUMP.com)

- Ground finish shaft & sleeve minimizes runout
- Magnetic drain plug assists with collecting foreign objects in oil cavity
- Power Ends ship fully assembled
- Quality SKF® bearings increase pump life
- Subassembly simplifies maintenance & inventory
- Replace instead of repair to save on downtime while ensuring factory built tolerances
- Fully interchangeable with existing Summit™ and Goulds® Pumps
- Upgrade to a 316 Stainless Steel **Forever Frame™** Power End to garner the thermal and corrosive advantages of 316 Stainless Steel
- ANSI/ASME B16 compliant
- Available in a variety of shaft & sleeve material combinations
- Quality hybrid bearing isolators protect your pump's bearings